

SPECIFICATION NOTES

SITE PREPERATION / SOIL WORKS
Any existing treets marked for retention shall be protcted for the duration of the construction works.
All perennial weeds such as oxalis, onion weed and the like shall be removed from the site.
No regrading is to be carried out within the drip line of the stres to be retained, if excavation is required, use hand methods to avoid any damage to the tree, or its roots.
Do not cut greater then 50mm.
Cut roots cleanly with a saw, and do not seal any wounds.

SOIL WORKS
Thoroughly cultivate the subsoil to a depth of 200mm, supply and install to a depth of 300mm the following soil mix.

SOIL DEPTH
Turf - 150mm
Planting - 300mm
SOIL MIX
Black Loam - 60%
Coarse washed river sand - 40%
Organic layer 50mm deep
Cultivate a 50mm later of organic and mix into the top of 100mm of soil mix.
ADDMIX COMPOSITION
Treated hardwood sawdust - 30%
Pine park fines - 40%
Composted Manure - 30%

Tree planting areas to be mounted 300mm above the existing ground line to improve draining from planting holes.
Tree holes to be excavated two times larger then the root ball and backfill with soil mix as specified above.

ON SLAB PLANTERS
Drainage Layer
After waterproofing of planters, lay drainage, which shall include:
- 40mm atlantis drainage cell or similar approved.
- Filter fabric equivalent to ICI terra firma 700.
- Washed river sand layer 50mm in depth

LIGHT WEIGHT SOIL MIX
Light weight soil mix shall be composed of the following materials and mixed in the given procedure a material with a ph. range of 6.0 -6.5
- 30% Black Loam
- 30% Double washed course river sand
- 20% Botany Humus
- 10% Composted bark fines
- 10% Composted Hardwood sawdust

MULCH
Supply and place 75mm layer of pine park horticultural grade mulch, graded in size 15mm x 15mm, free from wood silvers, set down 25mm from adjacent pavings.

PLANT MATERIALS
All plans and vegetation shall be true to type, of heathy growth, and free from any disease, should any change be required, the designed must be notified,
and council must be made aware. No variegated strain shall be used. Allow for slow release fertilizer to all plants applied at the manufacturers recommended rate
to be same or similar to osmocote.

FERTILIZER
Mass planted areas: Allow two shirleys slow release kokei pellets per 5 - 35 litre plant and one per 150mm plant turf areas: allow Shellys No. 17 Lawn fertilizer or equivalent, applied in accordance with the manufactures details / instructions.

STAKES AND TIES
Durable hardwood, straight, size shall be:
50 x 50 x 180, with ties spaced approximetly 300mm apart.
Stakes shall be driven in into the ground at 600mm.
Ties shall be 50mm Hessian Webbing fixed in a figure of the eight pattern.

PLANT ESTABLISHMENT PERIOD
From the date of completion, there shall be a period of 26 weeks from the planting establishemnt period. any plants which fail during that period are to be replaced with the same type and species. The mulched surfaces shall be maintained in a neat and tidy state. Grass shall be mowed on a regual basis when required in order to maintain a healthy ground cover, and a constant water regiem will be maintained to enure all plants remain healthy.

IRRIGATION
All planting areas must be supplied with a fully automatic irrigation system, shrub risers and pop-ups on PVC laterals. The irrigation system must meet all the requirements of the water board and electricity supply authorities and all the Australian Standards. Irrigation heads to be equivalent to Toro 570 sprinklers. Provide richdel or similar approved controller. Connection to water board mainsto be through an approved reduced pressure zone device installed to the water board regulations.

Particular attention should be maintained by the contractor to ensure minimal overspray onto paths or surrounding properties/buildings.

BASIX COMMITMENTS:

The applicant must plant indigenous or low water use species of vegetation throughout 10 square metres of the site.

ADDITIONAL NOTES:

at least 50% of the overall number of trees and shrubs are native to the region (Regarding the design guide)

at least 25% of the area of the lot forward of the building line must be landscaped.

LEGEND & NOTES

- TREE TO BE REMOVED
- TREE TO BE RETAINED
- STRUCTURES TO BE DEMOLISHED

PROPOSED LANDSCAPE PLAN

1 : 200

LANDSCAPE CALCULATON AND COMPLIANCE

MINIMUM LANDSCAPE - N/A - 2.5M FOR THE FRONT ONLY.

3M PROPOSED FORWARD OF BUILDING LINE.

HARRIS STREET

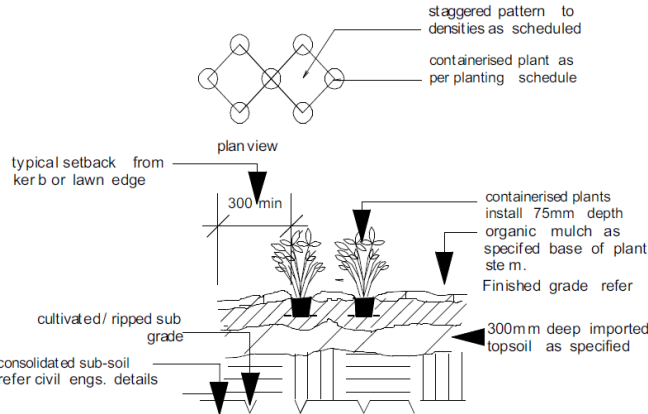
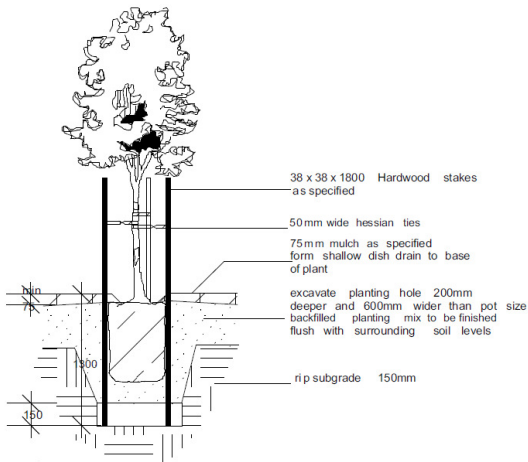
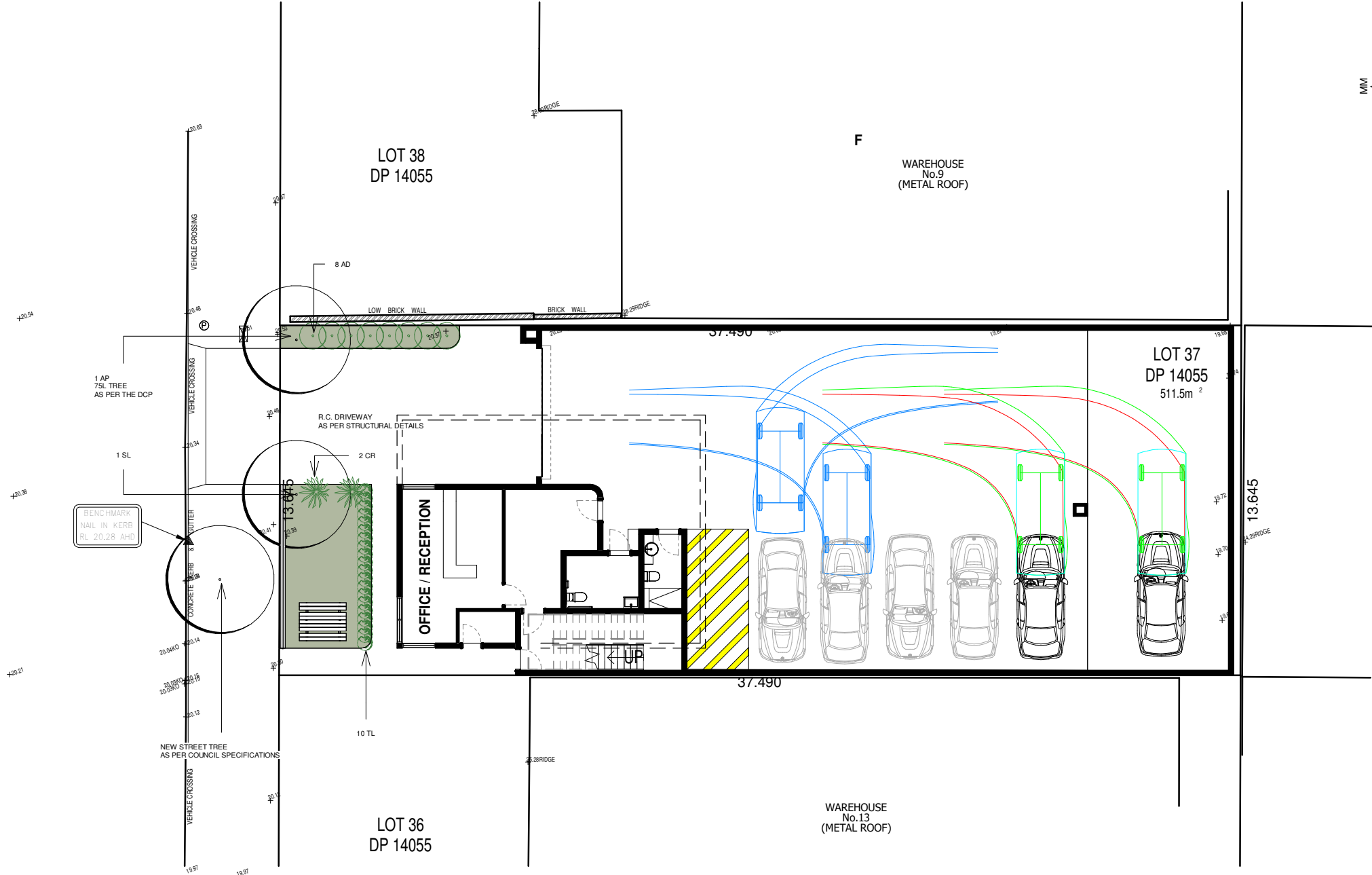

PLANT SCHEDULE			
PLANT / TREE NAME	HOW MANY ON SITE	POT SIZE	MAT. HEIGHT
LP - LILLY PILLY (STREET STREET)	0	45 L	6M - 10M
AP - ACACIA PARRAMATTENSIS	1	75 L	9M
SL - SYZYGIIUM LEUMANHII	1	45 L	8M
CS - CALLICOMA SERRATIFOLIA	0	45 L	8M
AD - ALTERANTHERA DENTATA	8	200 MM	0.7 M
TL - LOMANDRA TANIKA	10	200 MM	0.5 M
CR - CYCAS REVOLUTA	2	200 MM	1.2 M
GA - GARDENIA AUGUSTA FLORIDA	0	200 MM	1.2 M
CO - CALLISTEMON CAPTIN COOK	0	200 MM	0.5 M
LAWN			
TRUF		45	
Sir Walter Buffalo		msq	

Maintenance Task	J	F	M	A	M	J	J	A	S	O	N	D
Care of Plants												
Monitoring	Y	Y	Y	Y	Y	Y	Y	Y	Y	Y	Y	Y
Pruning (if needed)	Y	Y	Y	Y	Y			Y	Y	Y	Y	Y
Deadheading/Tip Pruning	Y	Y	Y	Y	Y			Y	Y	Y	Y	Y
Fertilise - Slow Release								Y				
Fertilise - Rapid Soluble as needed	Y	Y	Y	Y				Y	Y	Y	Y	Y
Cut Back Perennials and Grasses		Y	Y									
Watering (as needed)	Y	Y	Y	Y	Y			Y	Y	Y	Y	Y
Garden Beds												
Edging	Y	Y	Y	Y				Y	Y	Y	Y	Y
Weeding	Y	Y	Y		Y			Y	Y	Y	Y	Y
Mulching	Y							Y				
Leaf Removal				Y								
Pest Management												
Moitoring	Y	Y	Y	Y	Y			Y	Y	Y	Y	Y
Lawns												
Fertilise								Y		Y		
Seeding where needed									Y			
Winter Clean up							Y					

SHN LANDSCAPE STUDIO

SHN LANDSCAPE STUDIO

SYDNEY - 13 LOOKSLEY ROAD, BEKLEY

EMAIL: INFO@SHN.COM.AU

PHONE: +61 481 319 906

11 Harris Street, Condell Park

LANDSCAPE PLAN

ISSUE	DESCRIPTION
A	ISSUED FOR DEVELOPMENT APPLICATION

09/14

Scale: As indicated @ A2

11/10/2024 5:27:42 PM



DRAWN - HS

CHECKED - IB

COPYRIGHT:
This document is COPYRIGHT and the property of SHN LANDSCAPE STUDIO. It is not to be retained, copied or used without the prior written permission.

GENERAL NOTES
- Do not scale drawings, use figured dimensions only.
- All dimensions and levels are to be verified on site before any work commences.
- All work is to be carried out in accordance with the AS and NCC standards.